

# \$0 - 20710 111 Avenue, Edmonton

MLS® #E4412709

**\$0**

0 Bedroom, 0.00 Bathroom,  
Land Commercial on 0.00 Acres

Winterburn Industrial Area East, Edmonton,  
AB

Property entails several industrial lots with flexible sizes FOR LEASE. Lots sizes ranging from 1, 2, 2.3, 3, 4, 5, 6 and up to 10 Acres contiguous. All lots are compacted gravel/concrete, 6ft chain-link fence, and 3-phase power connection.

## Essential Information

MLS® #	E4412709
Bathrooms	0.00
Acres	0.00
Type	Land Commercial
Status	Active

## Community Information

Address	20710 111 Avenue
Area	Edmonton
Subdivision	Winterburn Industrial Area East
City	Edmonton
County	ALBERTA
Province	AB
Postal Code	T5S 2G6

## Additional Information

Date Listed	November 5th, 2024
Days on Market	169

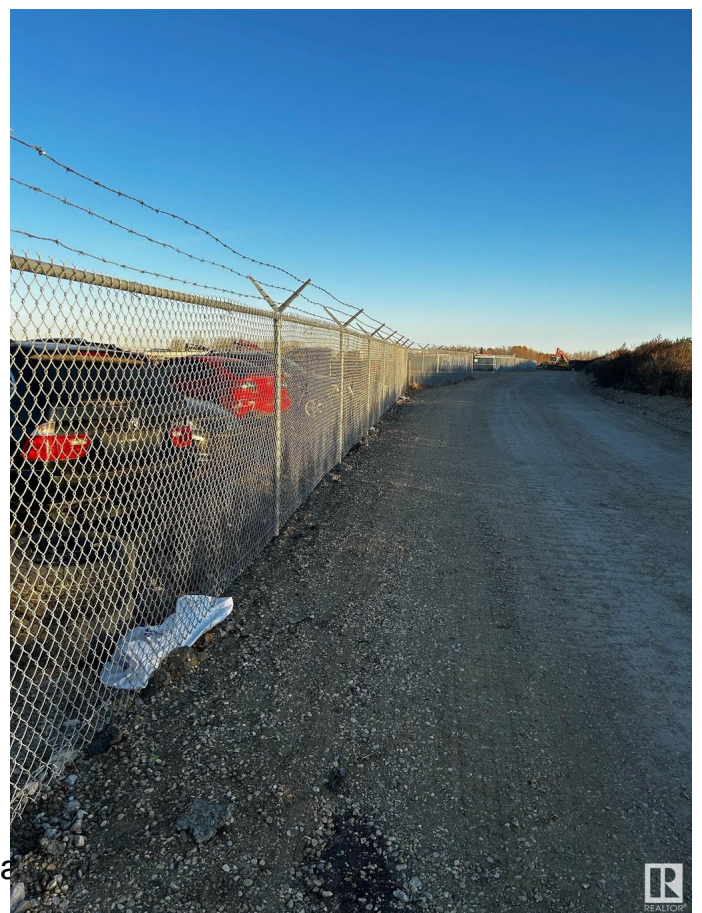

DATA IS DEEMED RELIABLE BUT IS NOT GUARANTEED ACCURATE BY THE REALTORS® ASSOCIATION OF EDMONTON. COPYRIGHT 2025 BY THE REALTORS® ASSOCIATION OF EDMONTON. ALL RIGHTS RESERVED. Trademarks are owned or controlled by the Canadian Real Estate Association (CREA) and identify real estate professionals who are members of CREA (REALTOR®, REALTORS®) and/or the quality of services they provide (MLS®, Multiple Listing Service®)

Listing information last updated on April 23rd, 2025 at 8:17pm MDT